

TMT

THE MISSION THEATRE

TECHNICAL SPECIFICATION

Contact Details & General Information

On January 24th 2005, The Mission Theatre opened its doors to Bath audiences for the first time. Now, The Mission has become a highly popular and well-loved part of the Bath cultural scene.

The attractive Grade II listed building that Ann and Andrew Ellison, founders of Next Stage, first saw in 2002 had been derelict since The People's Mission had ceased to worship there in 1998. The potential for the building to become a versatile arts venue was apparent from the outset, particularly to a theatre company specialising in theatre in-the-round performances.

Theatre Director	Ann Ellison	nextstagebath@aol.com 01225 428600
Theatre Manager	Rowan Bendle	
Stage Manager	Andrew Ellison	
Technician	Joe Sullivan	

Any initial queries should be directed to the Theatre Director or Manager.

Find Us

The Mission Theatre

32 Corn Street, Bath

BA1 1UF

Public Transport Directions

Bath Spa Train Station and Bath Bus Station are a two-minute walk away. Park and Ride and all main bus routes have stops within a minute's walk of the Theatre. There is a taxi rank at the train station.

Road Directions

Located in the heart of Bath, The Mission Theatre is directly opposite the entrance to Avon Street Car Park.

Loading

Loading is via the front door from street level up two small steps. Minimum door size is 1.26M wide by 1.95M high. Alternatively, access is available from the stage left door via the Green Room using two doors of standard pedestrian entry size.

Main Auditorium

Maximum Capacity – 150

Stage Dimensions

In-the-round: 6.03M x 6.28M

End On: Semi-circular stage with a front apron. Apron is 4.911M wide x 1.423M deep. Semi-circle max depth is an additional 2.047M with an overall max depth of 3.47M. Accessed stage left by two steps and stage right by 4 steps down from dressing room. A fixed set of royal blue tabs are situated on a tab track on the downstage edge of the raised stage.

Tabs out width: 8.6M

Proscenium Height: 5.38M

Thrust: 5.45M x 9.15M floor space with tabs closed. Semi-circular stage with front apron adds 3.47M depth making it 5.45M x 12.62M with tabs open.

Access between FOH & Backstage when the house is open is around the exterior of the building.

Under no circumstances must **anything** be screwed/drilled/fixed into the floor.

Full Auditorium Dimensions

Length: 9.66m (13.65 including semi-circle raised area)

Width: 10.45m

Height at sides: 4.5M

Height at centre: 5.36M

Rig trim height: 4.2M

Rooms and Furniture

The Capsule

2 story building at the rear of The Mission Theatre provides changing room facilities for large casts. Hanging rails, wall mounted Dimplex heaters and free-standing mirrors provided on both floors. Access to The Capsule is via the Stage Right dressing room.

Dressing Room

3m x 2.7m - 5 'stations', Dimplex wall heater, lights must be off during show.

Green Room

2.57m x 2.45m – 2 'stations', Dimplex wall heater, WC/WHB plus sink unit.

The Capsule provides a backstage crossover from stage right to stage left via the ground floor into the Stage Door into the green room.

Access Equipment

1 x Zarges A frame 8 rung ladder Z600 (Model:41521)

Show Relay

Show relay is available via speakers positioned in The Capsule, The Green Room, The Control Room and in the foyer of the Mission Theatre fed from a fixed auditorium microphone.

Sound

We have a '4-way system' installed with a pair of speakers at the front of the auditorium (proscenium end) and a pair at the rear. It is possible for the rear pair to be used as foldback monitors should this be required.

Sound Equipment:

- Allen and Heath QU16 Digital Mixing Desk
- 3 x Denon CD Players
- 2 x EV SX300 Speakers
- 2 x EV SX150 Speakers
- 2 x QSC RMX850a Amplifiers

Patching and Tie Lines

Output patching is available in the control room. Speakon tie lines are positioned in the four corners of the auditorium with two XLR returns available at the HL edge of the proscenium.

AMP 1 INPUT	AMP 1 OUTPUT	AMP 2 INPUT	AMP 2 OUTPUT	AMP 3 INPUT	AMP 3 OUTPUT	AMP 4 INPUT	AMP 4 OUTPUT
Back House Left corner (By control room)		Front House Left corner (By Proscenium)		Back House Right Corner (Opposite to control room)		Front House Right corner (By Green Room)	
1A	1B	2A	2B	3A	3B	4A	4B

Patch Panel Layout

A default show file is loaded into the sound desk; this has a basic output patch designed to work with the default configuration of our system. Please create your own file if you wish to make changes and restore the default when you leave. If you wish to make changes to the patch, please only do so using the panel on the front of the rack, please also ensure you return the patch bay to its previous state.

Lighting

Ground supported truss over the in-the-round acting area. Truss dimensions are 8.8 x 8.37m with 2 mid spans. Maximum truss trim height is 4.3m from deck. Maximum uniformly distributed load is 200KG. There are two additional 48MM pipe positions located upstage of the proscenium on the left and right hand walls.

Control

ETC Element 2 lighting desk with 1024 outputs, 40 faders, built in keyboard and 22" LED optical touch screen with DMX output. A DMX tie line (5 pin) is positioned in the control room, this is a direct and permanent feed to the dimmers. There is no other DMX patch around the theatre.

Dimming

48-ways Zero 88 Chilli DMX dimming installed with 2 Socapex outputs at the base of each truss leg. Socapex and 15A spiders are provided to reach the trim height.

House Lights

House lights are controlled from a dimmer switch near the entrance door within the main auditorium. The House Lights cannot be controlled from the lighting desk.

Lantern Stock

- 14 x Strand Quartet Fresnel (500W)
- 17 x Selecon Acclaim Fresnel / PC (650W)
- 2 x Strand Cantata Fresnel (1kW)
- 2 x Source 4
- 1 x Source 4 Zoom
- 5 x Par 64 (1000W – Please enquire about lamp type)
- 1 x Selecon Acclaim 18-34 Degree Profile (650W)
- 1 x Source 4 Par (Please enquire about lenses)

All with barn doors (if appropriate), gel frames and safety bonds. Please contact the theatre to confirm exact availability of fixtures.

2 x Portable lighting stands and 2 x 3 way DMX dimmers are available on request.

Communications

Although there is no equipment available for use there are comms tie lines located around the theatre.

- Control room (x2)
- Stage Manager Position
- Green Room
- Dressing Room
- Outside of Control room – Rear House Left in entry area

Projector

Sanyo PLC-XU75 (VGA run from control room) – shutter controlled from control room.

Available for hire please, contact the theatre.

Staging

Q-Build Rostra are available to borrow. These measure 0.75M square and are easily lifted and joined in a variety of formats. There are 12 legs at 0.49M high, and two steps. There are also 12 lids, and linking devices are supplied.

Additional Equipment/Information

Smoke/Haze

Please check before using smoke or haze machines to confirm detectors, in relevant areas, are isolated.

Power

A 63 Amp 3 Phase Socket is available at the rear of the auditorium.

Radio Frequencies

The mission theatre does not hold licenses for the use of radio/wireless microphones or equipment. The hirer or visiting company is responsible for arranging appropriate licenses through Ofcom.

Electrical Safety

Any electrical equipment entering the building must carry a valid electric safety mark and PAT sticker. The theatre reserves the right to prevent visiting companies from using anything found without this.

Pyrotechnics

If pyrotechnics are to be used permission must first be sought from the theatre well advance of your arrival. All systems must be key operated by a competent person. Test fires will be requested before the performance.

Keyboard

Yamaha P-95B keyboard available for hire – please contact the theatre.

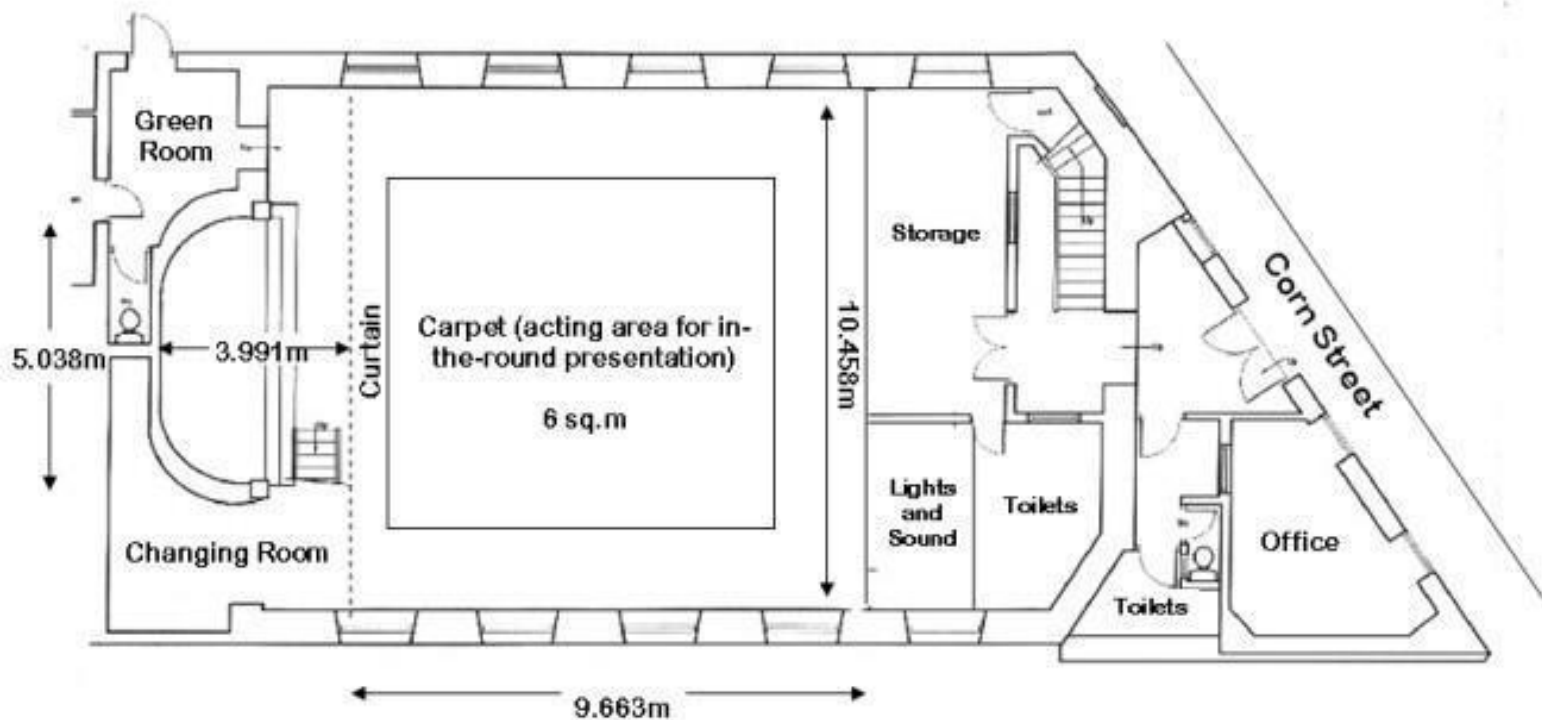

Lower Floor -The Main Auditorium etc.

Seating, staging and rostra are flexible, permitting end-on, thrust or in-the-round presentations

The Theatre Upstairs

Maximum Capacity – 50

The Theatre upstairs is accessed by 16 steps, there is no lift. There is one exit/entrance door for performers, crew and audience members.

Stage Dimensions

4.63M x 3.73M x 1.12M x 4.95M

Lighting

Stage lighting is hung from IWBs around the edge of the room.

Control

Zero 88 Level 12 Plus. A DMX tie line to the dimmers is located near to the lighting desk position.

Dimming

6 Ways of dimming. Hard patch available to IWBs around room.

Lantern Stock

Please contact the theatre to discuss.

Sound

There are Speakon tie lines located on stage and by the sound control position. There are also two XLR returns from the stage.

Sound Equipment:

- 1 x 4Ch Mixing Desk (2XLR/2Line)
- 1 x Denon DN_C615 CD Player
- 2 x EV-SX350 Speakers